

SAFETY PRECAUTIONS

The radio control model is not the toy!

It needs some technical requirements !

You must pay attention to the flying environment and correct operations

Read this instructions carefully when you assemble and fly

Children must fly with guardian.

Do not fly the glider in strong winds , rain, or at night .

Do not fly the glider in an area where there are many people.

Do not fly the glider Near homes , schools , or hospitals .

Do not fly the glider Near roads , railways or electrical lines.

Do not fly the glider Where there is the possibility of frequency
on the radio frequency from other gliders.

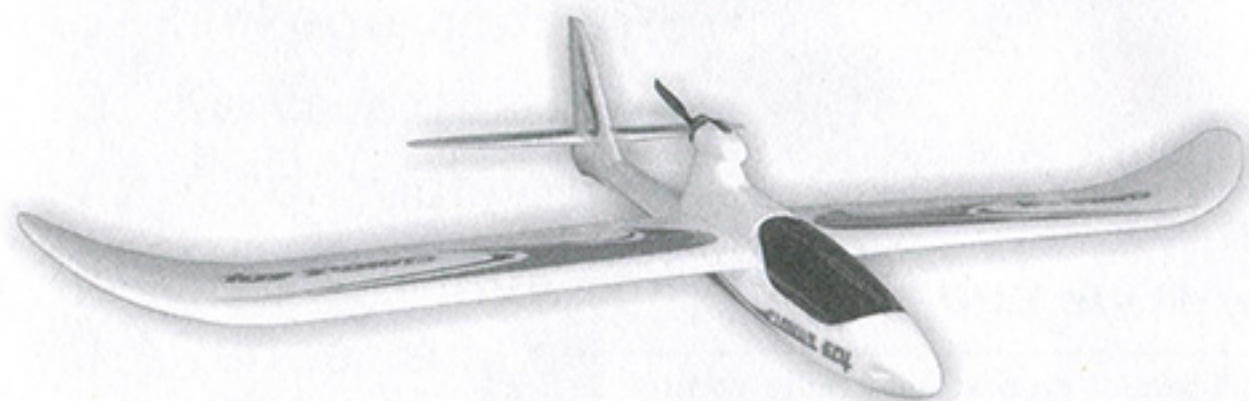

INSTRUCTION MANUAL

Before assembling, please read this instruction thoroughly.

CLOUDS FLY

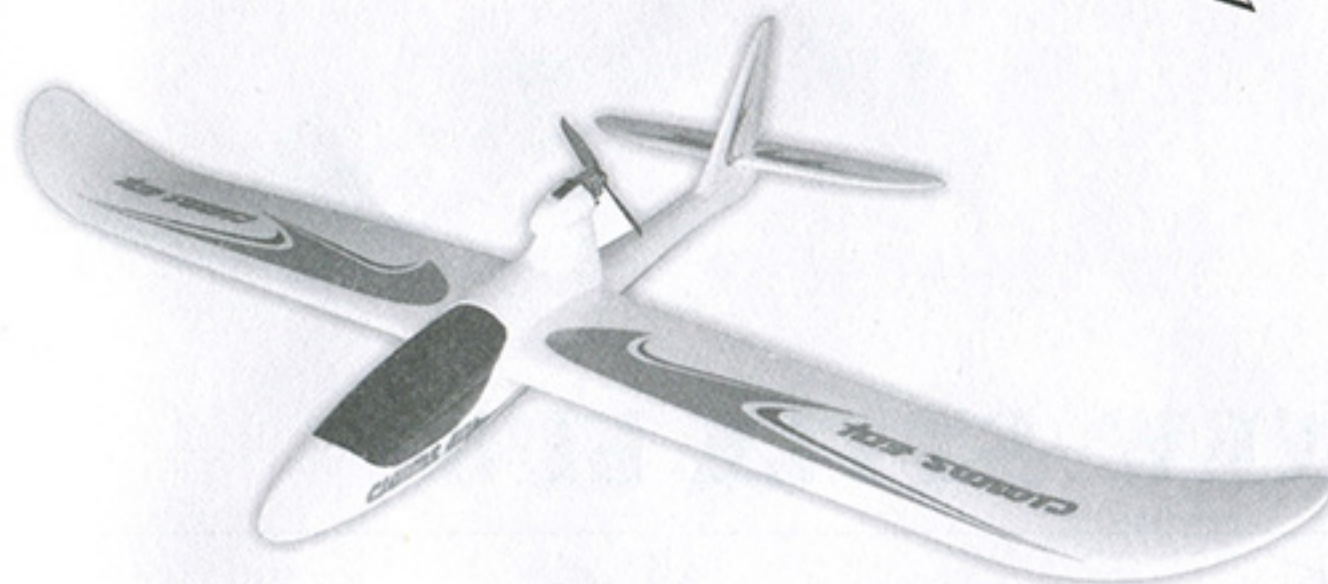

THE TECHNOLOGY PARAMETERS:

Wingspan: 1270mm

Length: 830mm

Flying Weight: 560g~600g

Motor: AX-2208 KV: 2200

CLOUDS

FLY

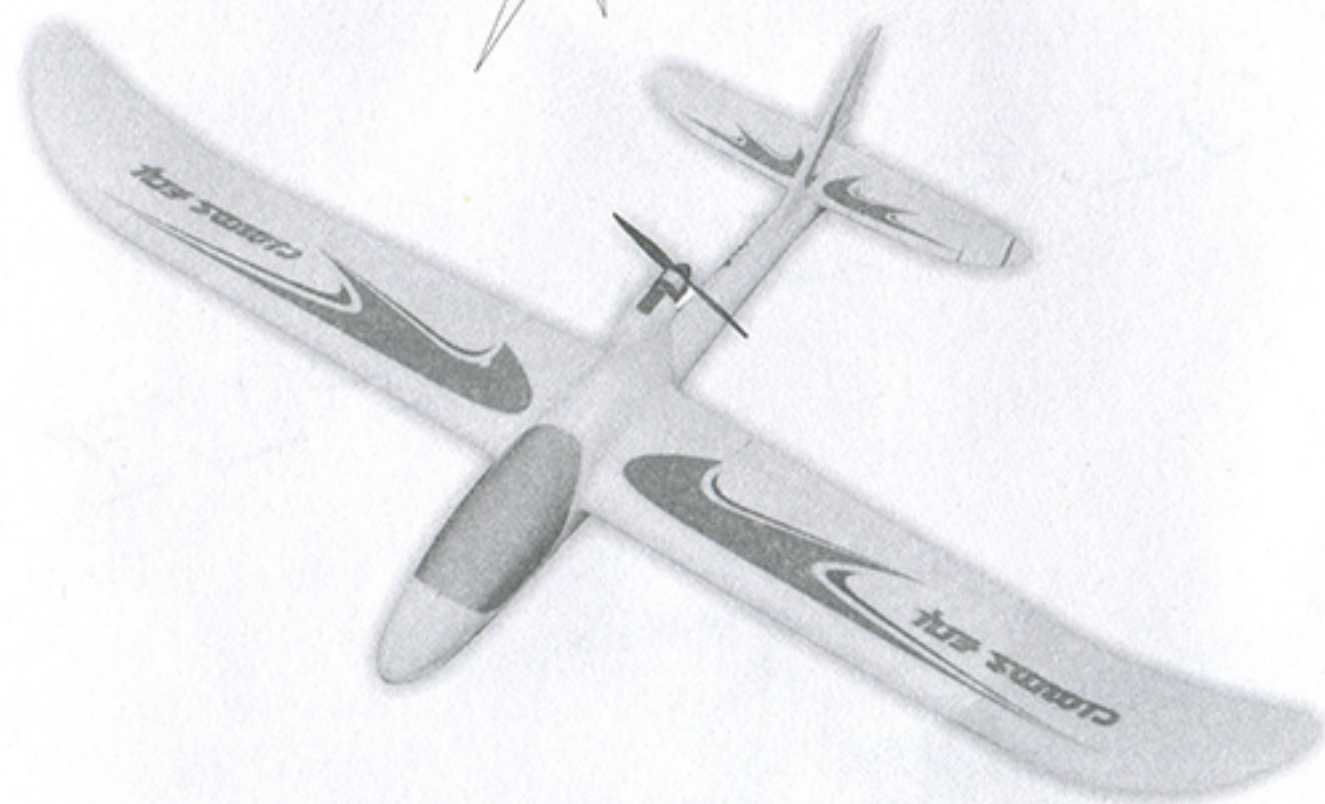

NEW-STYLE EPO

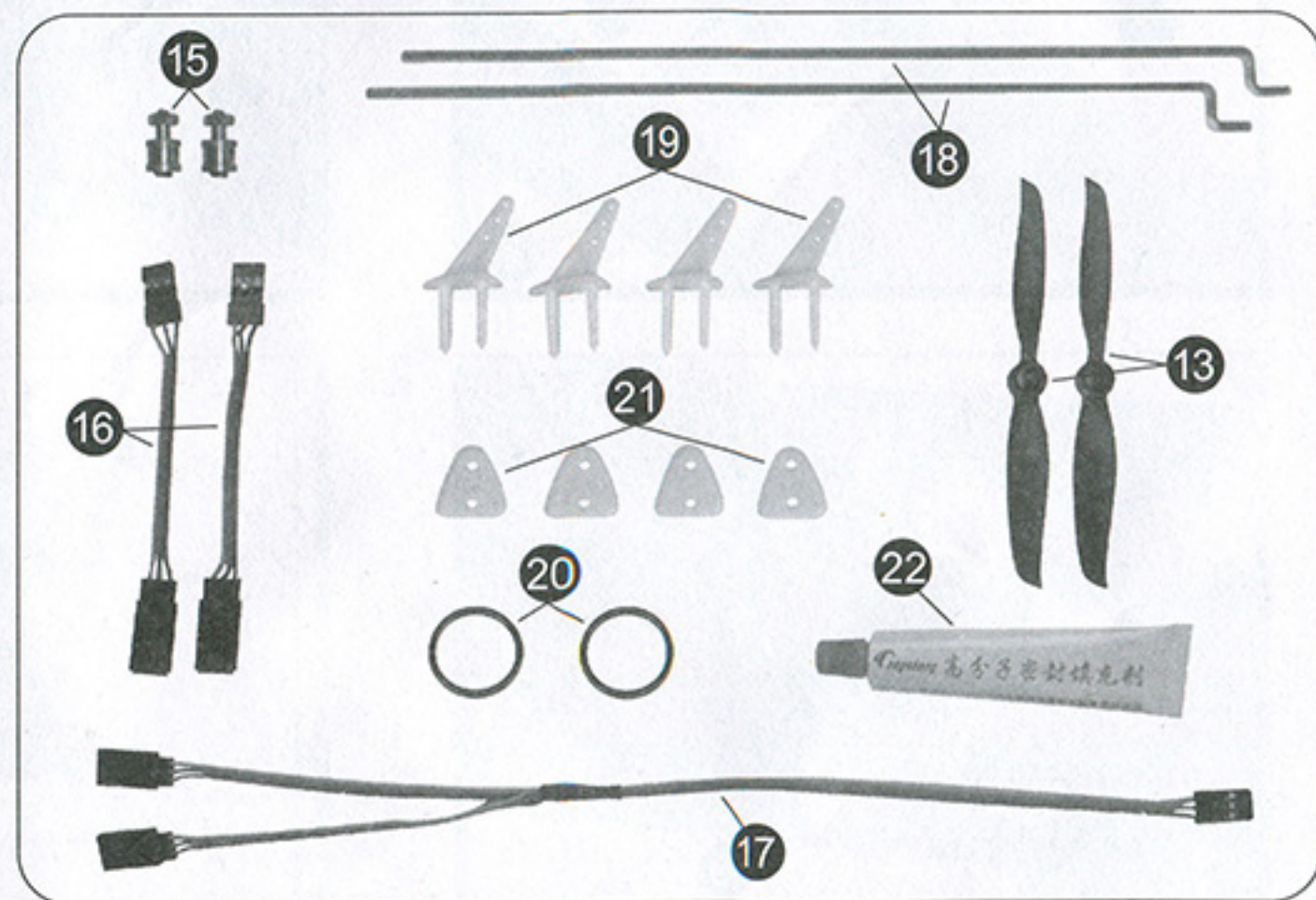
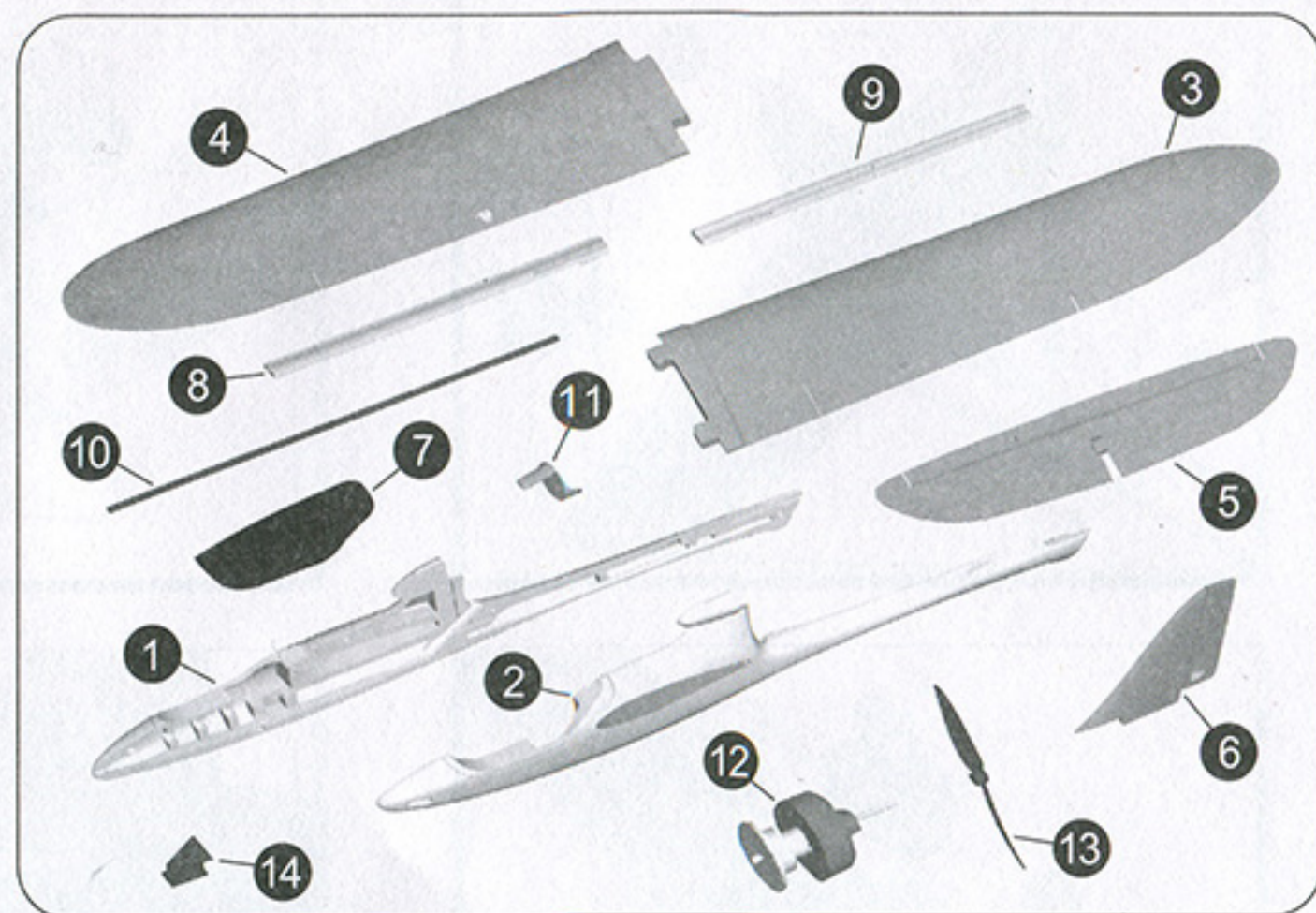
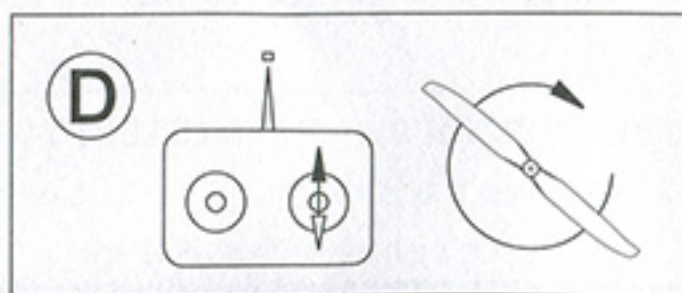
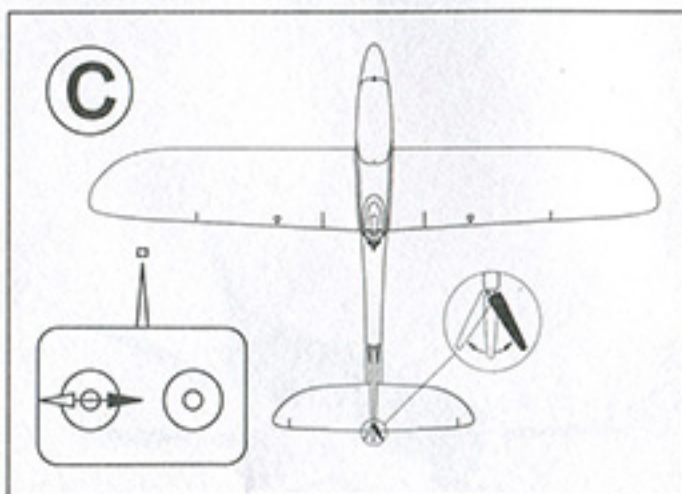
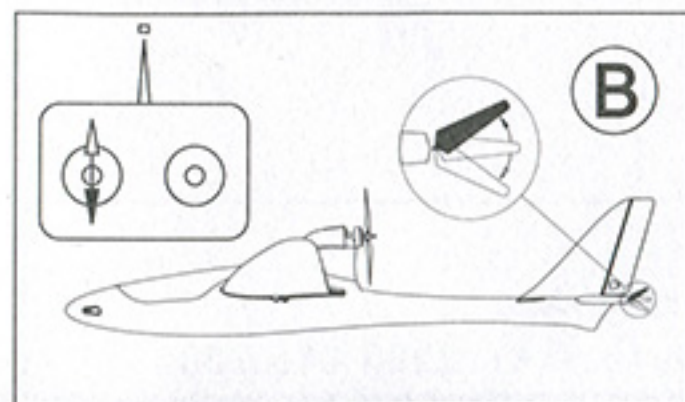
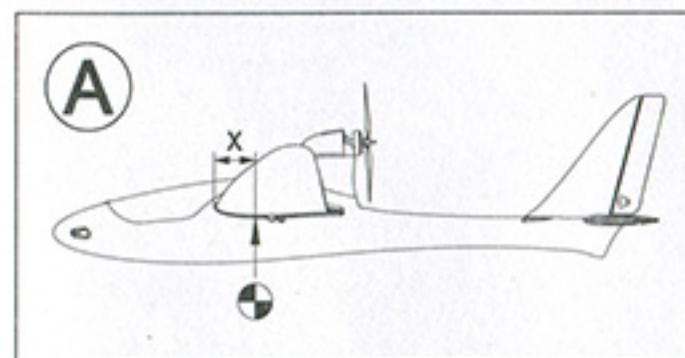

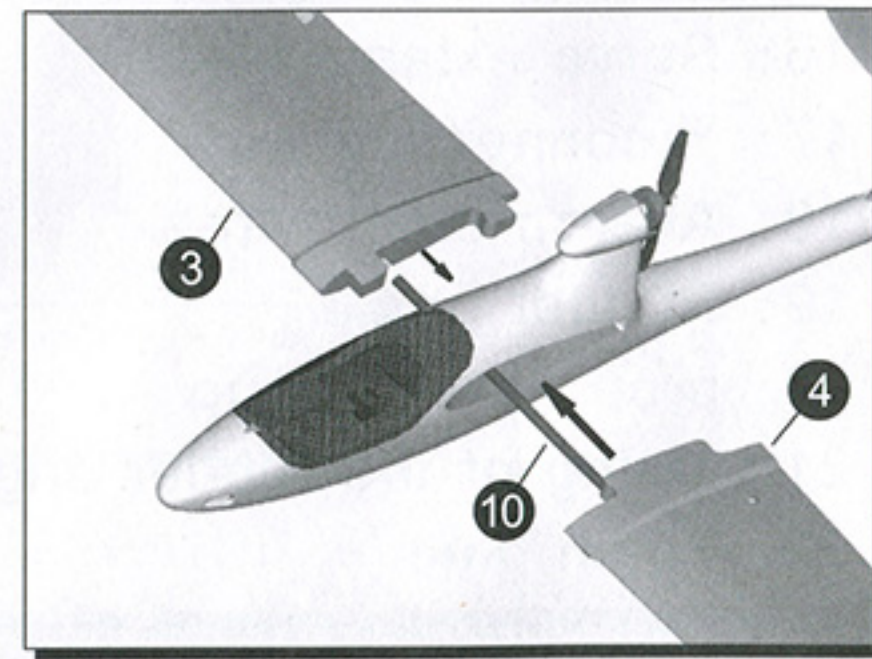
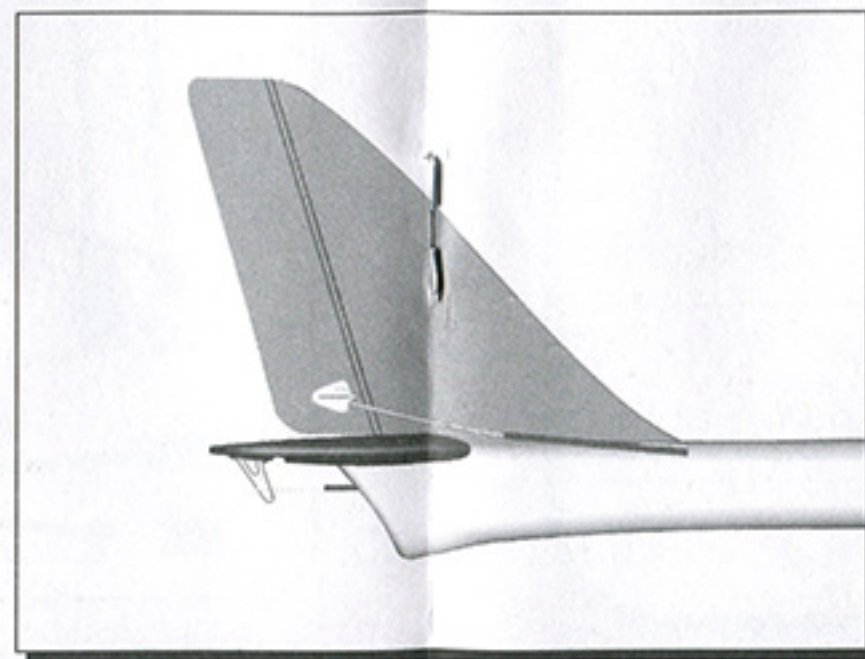
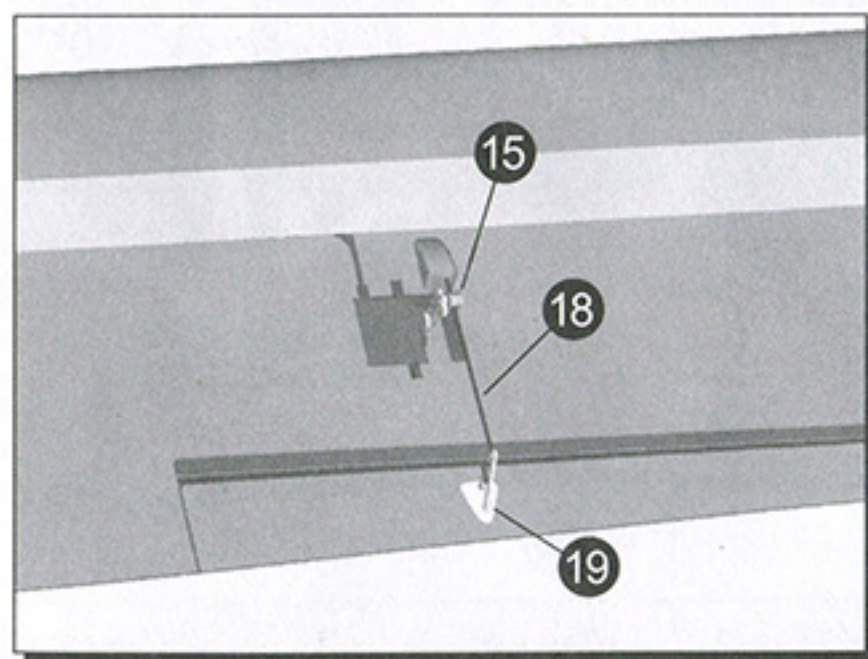
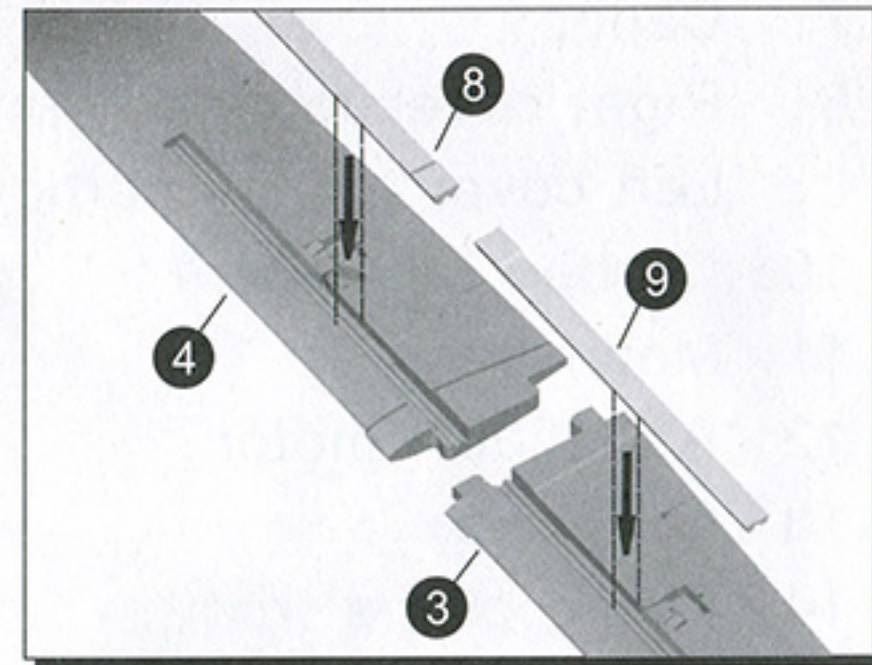
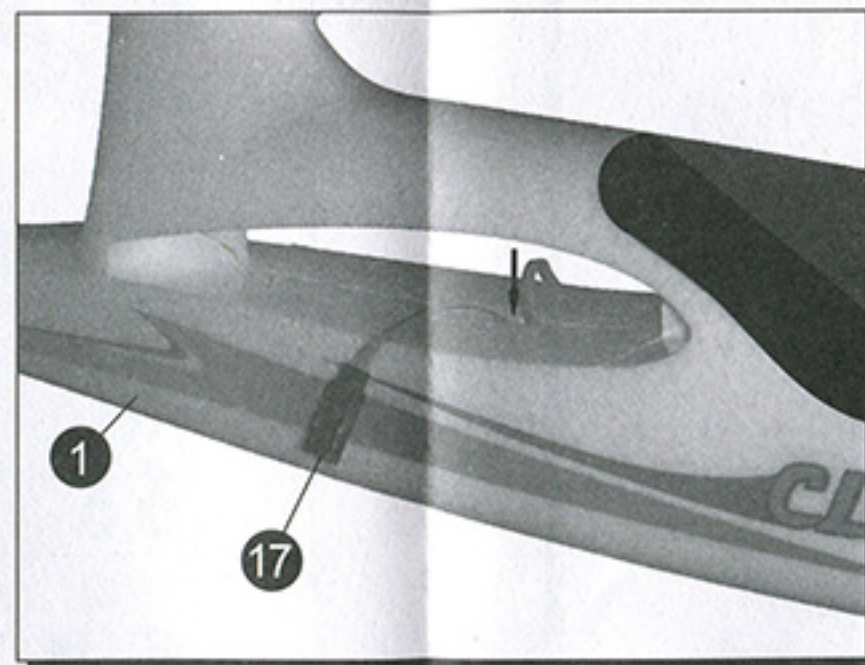
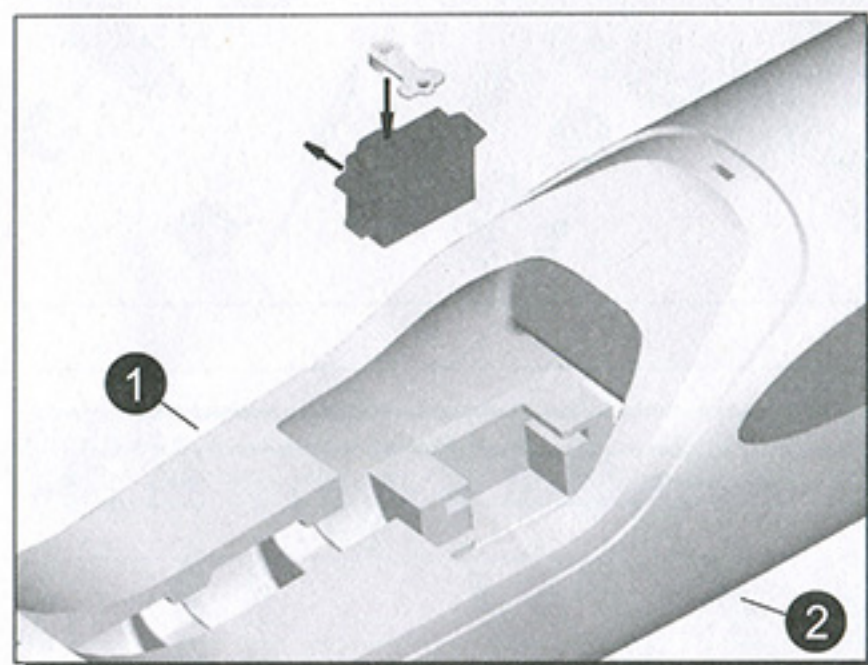
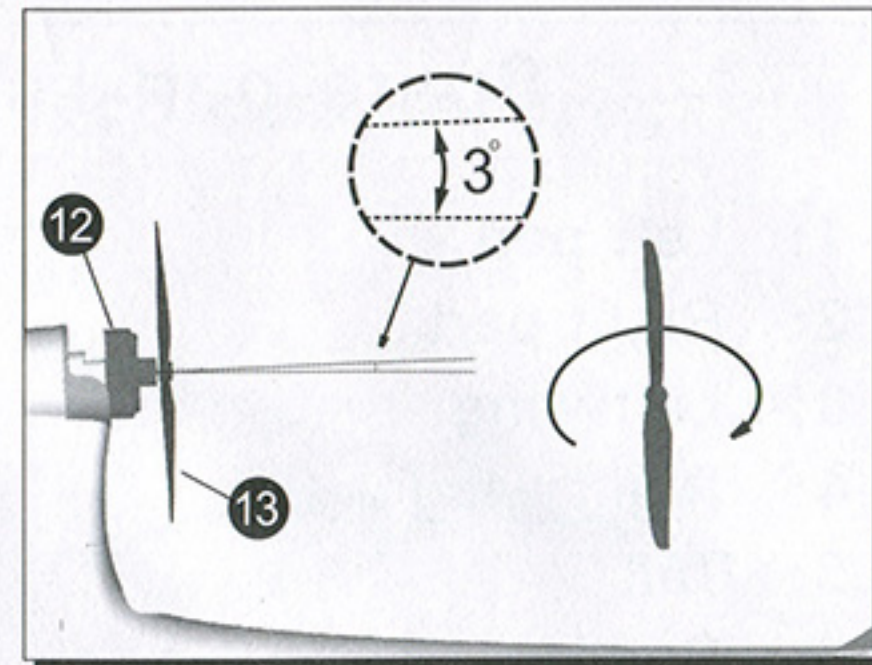
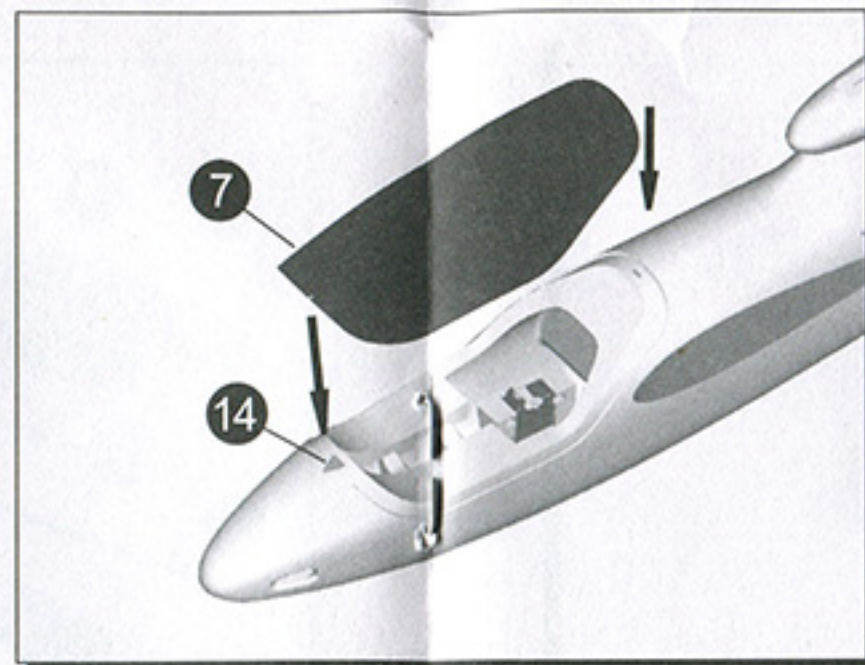
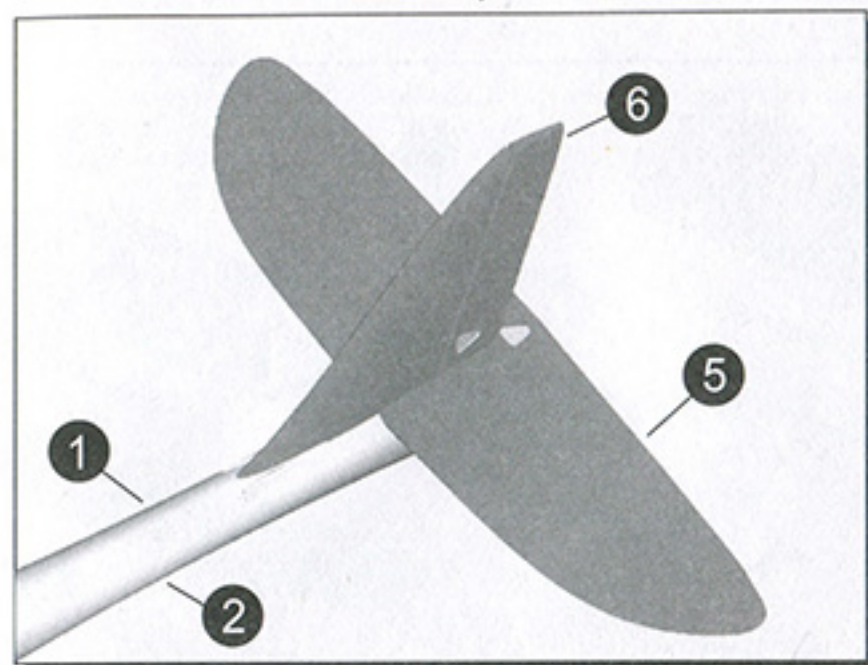

Spare part list

- 1: Left part
- 2: Right part
- 3: Left wing
- 4: Right wing
- 5: Tail
- 6: Rudder
- 7: Canopy
- 8: Right cover for the carbon shaft
- 9: Left cover for the carbon shaft
- 10: Carbon Fiber tube
- 11: Motor base
- 12: AX-2208N motor
- 13: 5*5 prop
- 14: Fixing of the front hatch
- 15: Linkage connector
- 16: Servo extend wire
- 17: Y connecting wire
- 18: Aileron steel wire
- 19: Rudder angle
- 20: prop saver O ring
- 21: Fixing of the rudder anger
- 22: Foam glue

OTHER RECOMMEND PRODUCTS

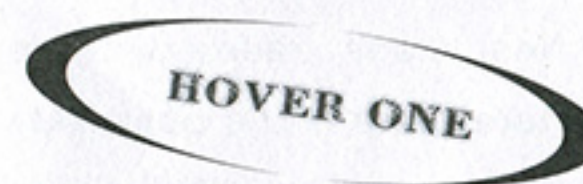
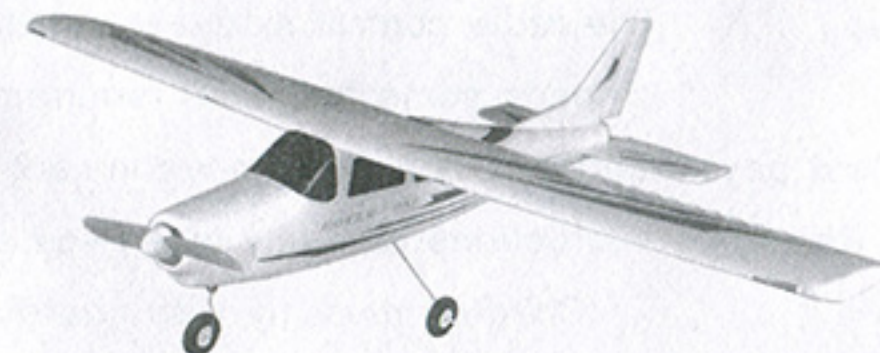

New-style EPO

FM4-Channel proportional radio control device
(Wthv-type mixed controller)
Radio control distance 300M

Ready Built
Motor: AX-2308N Wingspan: 1100mm Length: 850mm
Flying Weight: 655g Main wing area: 0.2m Battery: 1300/1500mAh (3CELLS)